

Dual Pole Master Disconnect Switch 500A/48VDC



Description

Cuts all battery power from vehicle electrical systems with applications needing switching of two circuits, or both positive and negative.

500A continuous current rating for each of the two circuits (using minimum 220 cable area).

Can be used to switch two vehicle voltage circuits simultaneously (24V and 12V).
Disconnect a battery or multiple batteries, in either the positive or the negative line.

Features and Benefits

- Ingress protection to IP67 and IP69K means that the switch can be mounted in exposed locations on the vehicle.
- Drop-in replacement for competitive Master Disconnect Switches, with higher vibration and shock capabilities.
- Direct lockout/tagout capability in On or Off position, with padlock or hasp.

Ordering Information

PART NUMBER DESCRIPTION

- M10033** Master Disconnect Switch **Black** handle
- M10030** Master Disconnect Switch **Red** handle
- M10039** Master Disconnect Switch **Yellow** handle



Specifications

Max Operating Voltage	48VDC
Max Continuous Current	500A per circuit, with minimum 220mm ² cable area. 350A per circuit, with minimum 110mm ² cable area.
Cranking Rating (30sec)	2250A per circuit, with minimum 220mm ² cable area. 1750A per circuit, with minimum 110mm ² cable area.
Inrush Rating (1 sec)	3000A per circuit with minimum 250mm ² cable area.
Terminal Stud Size	M12 x 25mm
Recommended Terminal Torque	20Nm (30Nm Max)
Temperature Range	-50° to 85°C, DC-Rated to 105°C
<small>Note: ambient temperature can reach 105°C with appropriate current de-rating. Stud terminals must never exceed 125°C under any condition.</small>	
Humidity	0 – 95% RH
Shock	30G
Vibration	8G
Ingress Protection	IP67 & IP69K
Recommended Mounting Torque	15Nm (20Nm Max)

Dimensions

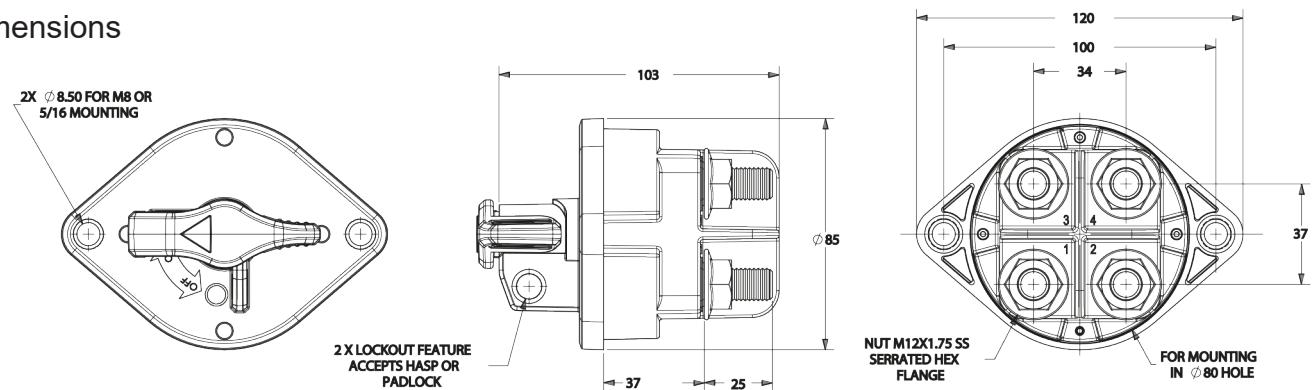

Configurations

